

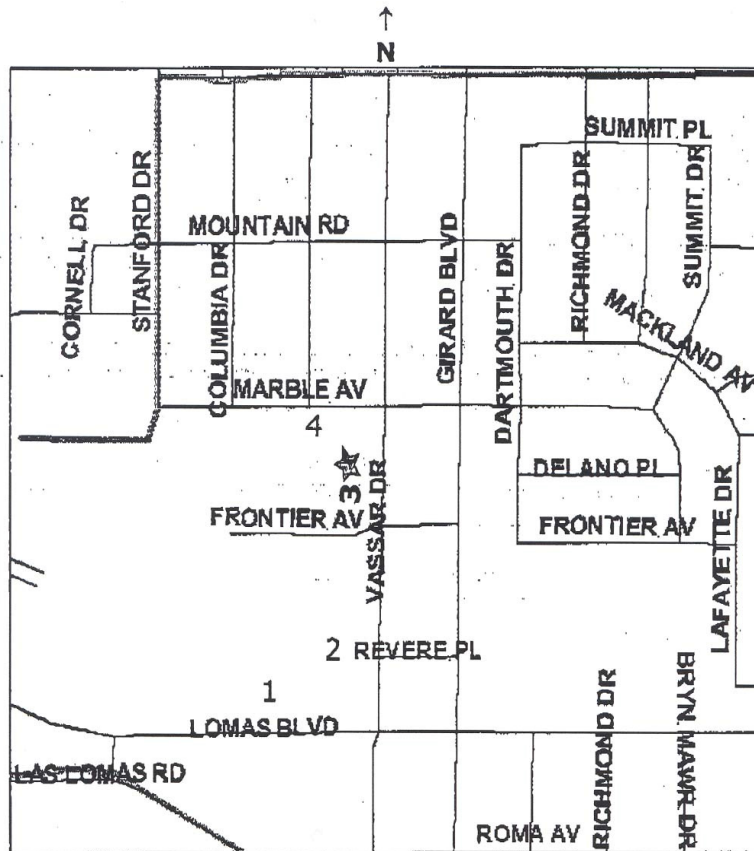

Center for Neuropsychological Services (CNS)
915 Vassar Dr. NE Suite 170
(Please access building on the West side)



Around us...

1. University Hospital 2211 Lomas Blvd. NE
2. USDH - Indian Health Services/PHS Indian Hospital 801 Vassar Dr. NE
3.  Center for Neuropsychological Services 915 Vassar Dr. NE
4. Mental Health Center 2600 Marble Ave NE

Directions

From I-25: Exit 225 Lomas. Travel East on Lomas Blvd. NE (past University Hospital) to Vassar Dr. NE. Turn left onto Vassar Dr. NE. Travel North on Vassar Dr. NE to Marble. Make a left hand turn onto Marble and enter at 2600 Marble. Drive East (across parking lot) and look for a large brown house with a redwood porch on your left hand side. You should see a little white sign that says: Dept of Psychiatry and the number 915 will be posted on the building.

Center for Neuropsychological Services (CNS)

915 Vassar Dr. NE Suite 170

(Please access building on the West side)

We look forward to working with you, please note the following considerations:

Our office is only accessible from the West side of the building. There are 3 parking spaces right outside of our clinic for patient use.

Parking is limited; if possible all members of the party should arrive together in one vehicle. If multiple vehicles are necessary, it is your responsibility to request an additional parking permit.

Park only in spaces marked "Patient Parking" located on the lot, and "Patient/Visitor Parking" at the Mental Health Center parking lot. You are responsible for any fines associated with parking illegally.

Make sure you have a yellow parking permit from our clinic and that it is dated for your visit today. The permit must be displayed on your front dashboard for Security to see.

Street parking is not allowed in the neighborhoods around the clinic. You may be ticketed or towed. You are responsible for any fines associated with parking illegally.

Thank you.

