

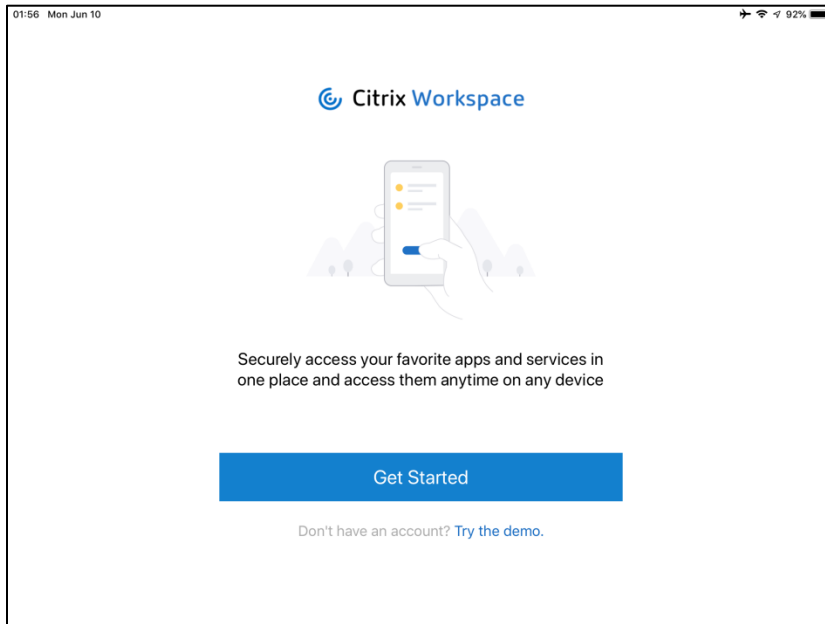

Apple Tablet Cerner Remote Access Setup

1. Download the Citrix Workspace app. Make sure that you are on the HSC_Guest (not HSC_Secure) or your home wireless network. From the main Citrix Workspace page, click Get Started.



2. Enter the following entries and click Continue.

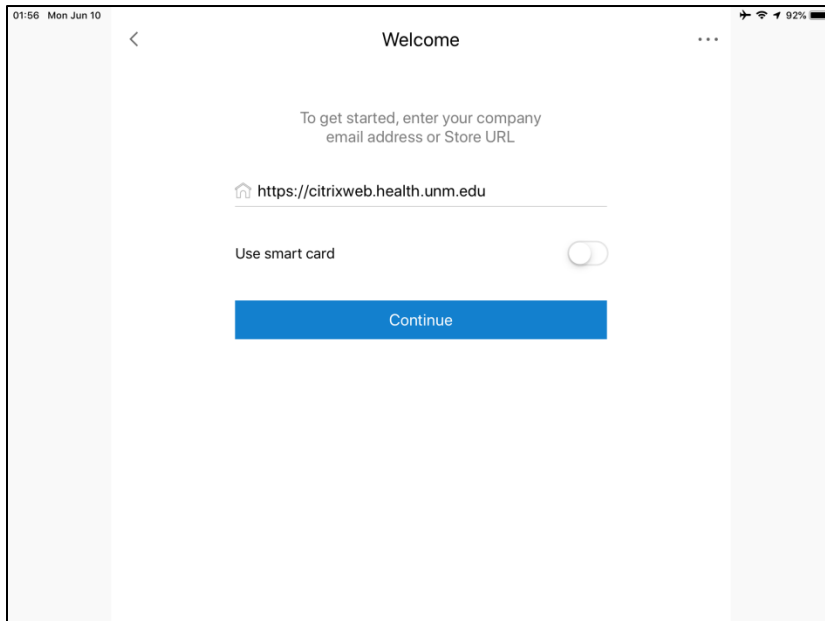

3. Enter the following entries and click Sign in.

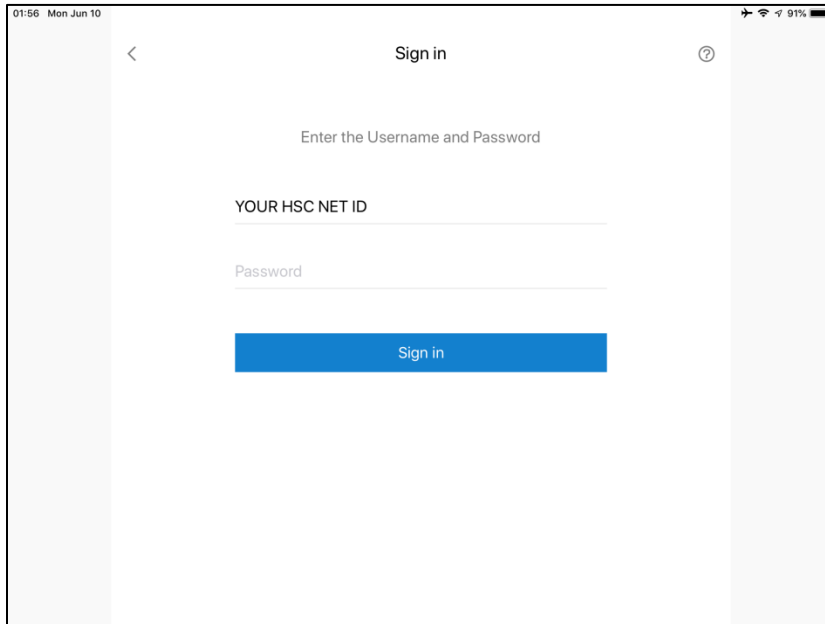

01:56 Mon Jun 10

Sign in

Enter the Username and Password

YOUR HSC NET ID

Password

Sign in

This screenshot shows a mobile application's sign-in screen. At the top, there is a status bar with the time '01:56', the date 'Mon Jun 10', and battery level '91%'. Below the status bar is a navigation bar with a back arrow on the left and a help icon on the right. The main content area has the title 'Sign in' and a subtitle 'Enter the Username and Password'. There are two input fields: 'YOUR HSC NET ID' and 'Password'. Below the input fields is a blue button labeled 'Sign in'.

4. Make a selection depending on if you use the Touch ID feature on your tablet or not.

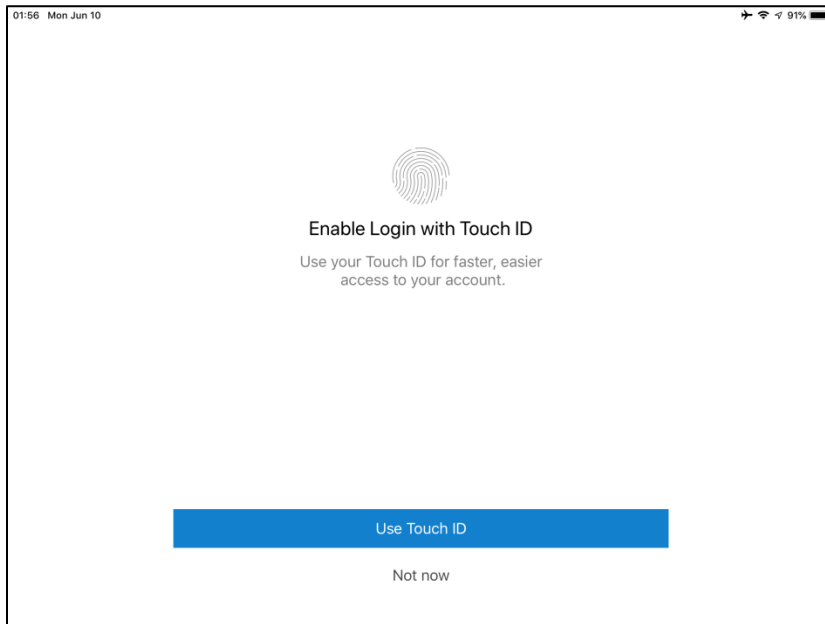

01:56 Mon Jun 10

Enable Login with Touch ID

Use your Touch ID for faster, easier access to your account.

Use Touch ID

Not now

This screenshot shows a mobile application's screen for enabling Touch ID login. At the top, there is a status bar with the time '01:56', the date 'Mon Jun 10', and battery level '91%'. The main content area features a fingerprint icon, the title 'Enable Login with Touch ID', and the subtitle 'Use your Touch ID for faster, easier access to your account.'. At the bottom, there are two buttons: a blue button labeled 'Use Touch ID' and a text link labeled 'Not now'.

5. Click Continue.

